

Philips Stadion

PRIVIUM®

PRIVIUM® HIGH POWER LEDSTRING

The high power LS512 LEDstring is an IP66 LED string solution designed with 7 LEDs per node and 60 individual nodes on a string. At full brightness each node produces an unmatched light output of up to 57 candela. This is twice the brightness of the first generation. Meaning a superior light output in combination with an easy-to-install LED string system. The LS512 is perfect for highlighting lines and edges and for backlighting contours, letters, symbols and lightboxes in signage applications or architecture.

PRIVIUM® HIGH POWER LEDSTRING



SPECIFICATIONS



| ARTICLE NUMBER | PRODUCT | COLOR TEMP K | LUMEN OUTPUT Lm/node | POWER W/node | EFFICIENCY Lm/W | CRI | VOLTAGE V | #NODES No* | IP RATING | TEMP °C |
|----------------|-----------------------------|-----------------|-------------------------|-----------------|--------------------|-----|--------------|---------------|-----------|------------|
| KLS5122720 | LS512-140° 60 Nodes 827 10M | 2700 | 148 | 1.2 | 123 | 80+ | 24 | 60 | 66 | -20 to 60 |
| KLS5124020 | LS512-140° 60 Nodes 840 10M | 4000 | 150 | 1.2 | 125 | 80+ | 24 | 60 | 66 | -20 to 60 |
| KLS5126520 | LS512-140° 60 Nodes 865 10M | 6500 | 160 | 1.2 | 133 | 70+ | 24 | 60 | 66 | -20 to 60 |

*Lumen values are typical, allow for color tolerance binning. Other color temperatures upon request.

*Leds 7 leds/node 6 nodes/M

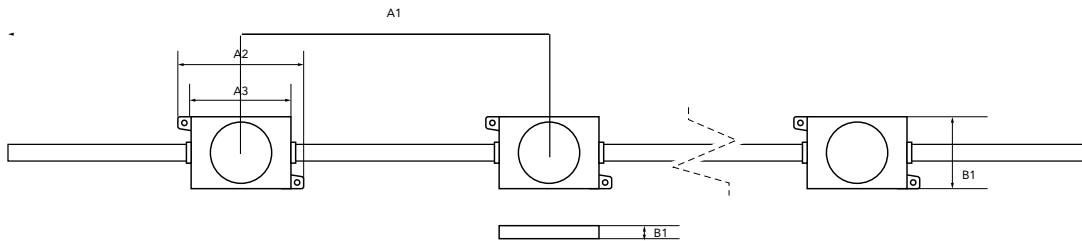

DIMENSIONS (MM)

| PRODUCT | A1 | A2 | B1 | C1 | # LEDS |
|-------------------------|-----|----|----|----|--------|
| LS512-140° 60 Nodes 10M | 190 | 57 | 31 | 7 | 420 |

LIGHT DIAGRAM

